

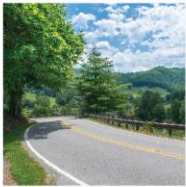

# NORTH CAROLINA

Department of Transportation



# Material Escalation Price Adjustment Request Submittal Process

Wiley W. Jones III, PE

August 4, 2022

# Participating in the Q&A Session

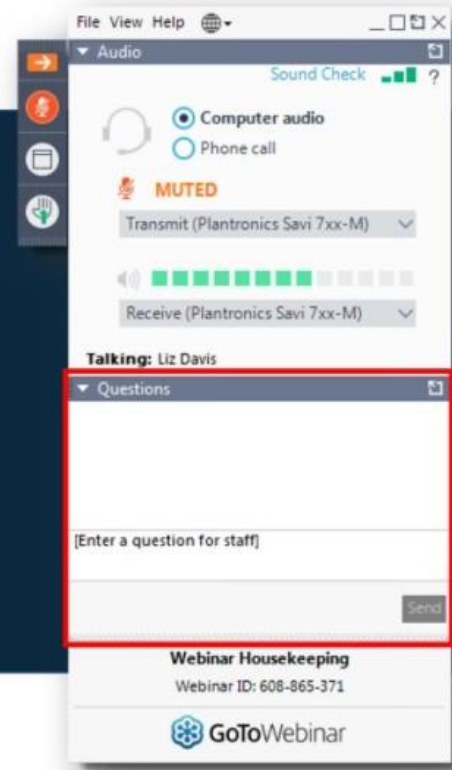
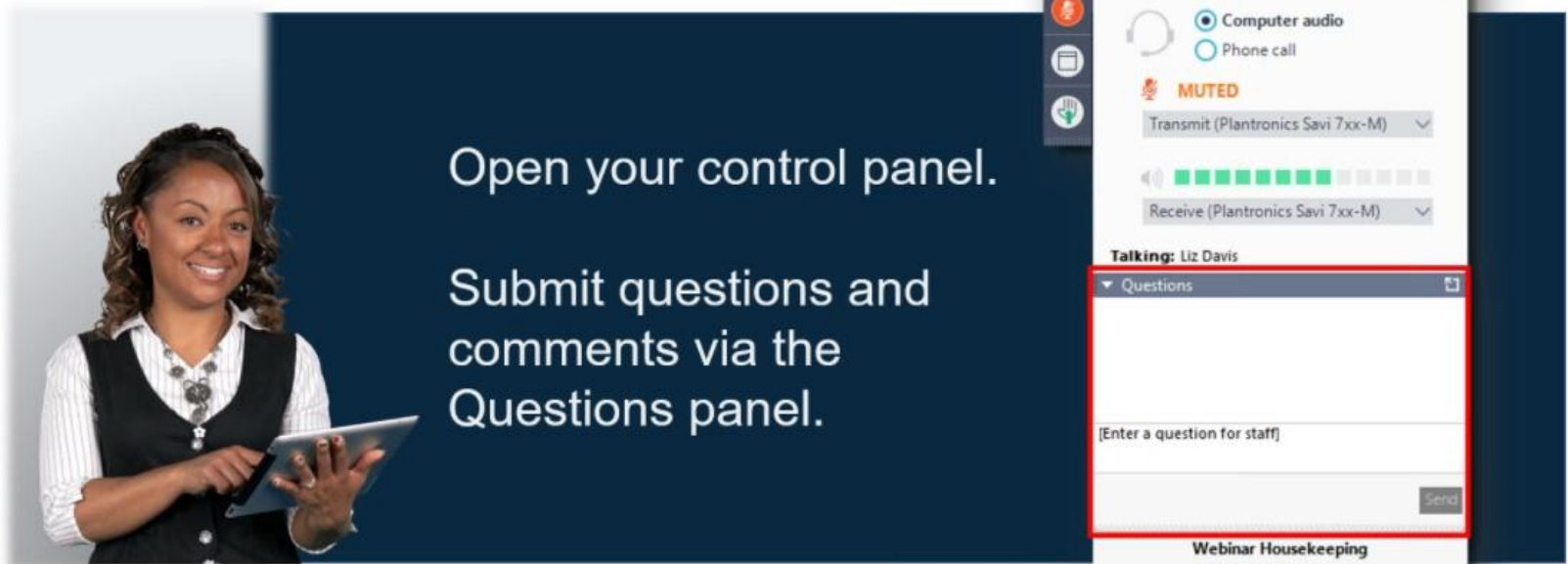

# Today's Webinar Topics

- NC General Assembly, Session Law 2022-74
- July 12, 2022 Memorandum from Chief Engineer
- Material Price Escalation Claim Form
- Examples of Documentation needed
- Answering some common questions



# NC General Assembly, Session Law 2022-74 Time Limited Cost Escalation Adjustment

- The General Assembly's Budget Bill provided for a Time-Limited Cost Escalation Adjustment.
  - Intent is to assist the road and highway construction industry to maintain resilience as it is confronted with extreme rise in construction material costs

# NC General Assembly, Session Law 2022-74 Time Limited Cost Escalation Adjustment

- Funds shall be used based upon increased construction material cost, if all of the following are met:
  1. Department Awarded contract on or before March 1, 2022, and either Contract performance was not completed, or Final estimate of the total contract cost was not completed by this date.
  2. Vendor makes claim, on form developed by the Department, within 60 days of enactment of this act.

September 10, 2022

# Chief Engineer's Memo



STATE OF NORTH CAROLINA  
DEPARTMENT OF TRANSPORTATION

ROY COOPER  
GOVERNOR

J. ERIC BOYETTE  
SECRETARY

July 12, 2022

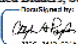
Memorandum To: NCDOT Prequalified Bidders, Subcontractors, and Suppliers  
From: C.A. Peoples, PE <sup>Transmitted by</sup>   
Chief Engineer  
Subject: Material Price Escalation Requests

Due to the recent volatility of materials, the North Carolina General Assembly, under Session Law 2022-74, has appropriated funding to support price adjustments for materials on NCDOT contracts. Price adjustments will be considered for materials that have been or will be permanently incorporated into the work on contracts awarded on or before March 1, 2022, where either contract performance was not completed, or the final estimate was not paid by this date.

Requests for price adjustments on contracts meeting the criteria above should be submitted by the prime contractor. Subcontractor and/or suppliers should submit price adjustment requests, along with supporting information, to their respective prime contractors. Requests submitted to NCDOT by subcontractors and/or suppliers will not be considered. Requests should be submitted as a single submittal per contract.

All requests for a price adjustment shall be submitted by no later than close of business on September 10, 2022. Any requests submitted after close of business on September 10, 2022, will not be considered.

The following conditions shall apply:

- Adjustments shall only apply to materials purchased after July 1, 2020.
- Adjustments shall only apply to materials that have been or will be permanently incorporated into the work.
- For materials that **have been** permanently incorporated into the work, an adjustment will be made based upon the invoice pricing at the time of purchase compared to the material pricing at the time of bid.
- For materials that **will be** permanently incorporated into the work, an adjustment will be made based upon the current quotes, invoices, or purchase orders compared to the material pricing at the time of bid.
- Adjustments shall be considered for materials only, and shall not include labor, transportation charges, etc.
- Adjustments shall not include profit or other markups.

Mailing Address:  
NC DEPARTMENT OF TRANSPORTATION  
OFFICE OF THE CHIEF ENGINEER  
MAIL SERVICE CENTER 1136  
RALEIGH, NC 27699-1136

Telephone 919-707-2300  
Fax 919-753-9426  
Customer Service 1-877-368-4968  
Website: [www.ncdot.gov](http://www.ncdot.gov)

Location:  
1 SOUTH WILMINGTON STREET  
RALEIGH, NC 27601

Requests should be submitted using the attached Microsoft Excel Spreadsheet titled 2022 Material Price Escalation Claim Form. The form can be downloaded from the following website: <https://connect.ncdot.gov/projects/construction/Pages/Construction-Resources.aspx>. Please save a copy of the form using one of the following appropriate naming conventions:

C20XXXXX\_Material\_Price\_Escalation\_Request\_2022-MM-DD.xls or  
DXXXXXXX\_Material\_Price\_Escalation\_Request\_2022-MM-DD.xls

The form, along with all supporting documentation, should be emailed to [NCDOTMaterialEscalationRequest@ncdot.gov](mailto:NCDOTMaterialEscalationRequest@ncdot.gov). Please use the naming convention shown above in the subject line.

Requests will be reviewed by the Department and a supplemental agreement will be executed to add a lump sum price adjustment to the contract. The lump sum price adjustment will be paid based upon the actual progress of the line items associated with the materials. Prime contractors receiving a price adjustment for work performed by a subcontractor/supplier shall distribute such price adjustments for the applicable work in accordance with Article 109-4(B) of the 2018 *Standard Specifications for Roads and Structures*.

Questions should be submitted to [NCDOTMaterialEscalationRequest@ncdot.gov](mailto:NCDOTMaterialEscalationRequest@ncdot.gov).

Attachment

CC: M.L. Sylvester, PE  
M.T. Gibbs, PE  
G.W. Burns, PE  
Division Engineers  
Division Construction Engineers  
Resident Engineers  
E.B. Tharrington, PE  
B.C. Skeens, PE  
W.W. Jones, III, PE  
M.H. Gaddy, PE  
Area Construction Engineers  
A.V. Earwood, PE  
Victor Barbour, PE  
Ellis Powell, PE  
John Sullivan, PE  
Brad Hibbs, PE



# Chief Engineer's Memo Highlights

- All requests for price adjustments shall be submitted by **no later than close of business on September 10, 2022.**
- Requests should be submitted by the prime contractor and should be submitted as a single submittal per contract.
  - Subcontractors and/or supplier should submit price adjustment price adjustment requests, along with supporting information, to their respective Prime Contractors.

# Chief Engineer's Memo Highlights

## Eligibility Requirements

- Contracts awarded on or before March 1, 2022, where either contract performance was not completed, or the Final Estimate was not paid by this date.
- Material Adjustment Requirements
  - Material must be purchased after July 1, 2020
  - Material must have been or will be permanently incorporated into the work
  - Adjustments are for materials only
    - Does not include labor, equipment, transportation charges, profit, markup, etc.



# Chief Engineer's Memo Highlights

## Work Already Performed

- For Materials that have been permanently incorporated into the work, an adjustment will be made based on
  - Invoice pricing at the time of purchase
  - Material pricing at the time of bid

## Work To Be Installed

- For Materials that will be permanently incorporated into the work, an adjustment will be made based on
  - Current quotes, invoices, or purchase orders
  - Material pricing at the time of bid

# Chief Engineer's Memo Highlights

- Requests should be submitted using excel spreadsheet
- Excel spreadsheet can be downloaded at:  
<https://connect.ncdot.gov/projects/construction/Pages/Construction-Resources.aspx>
- Should be named using one of the following approved conventions:
  - C20XXXX\_Material\_Price\_Escalation\_Request\_2022-MM-DD.xls or
  - DXXXXXX\_Material\_Price\_Escalation\_Request\_2022-MM-DD.xls

# How to find the spreadsheet?



The image shows a screenshot of a Google search for "ncdot connect". The search bar at the top contains "ncdot connect". Below the search bar, the results are displayed. A large blue arrow points to the first search result, which is "https://connect.ncdot.gov : Connect NCDOT: Home". The description for this result is "Bringing Business and Government together with online collaboration. You've visited this page many times. Last visit: 7/28/22". Below this result, there are several other links: "Bidding & Letting", "Resources", "Doing Business", and "Projects". At the bottom of the results, there is a link for "More results from ncdot.gov »".

ncdot connect

ncdot connect - Google Search

google.com/search?q=ncdot+connect&rlz=1C1GCEB\_enUS999US999&oq=ncdot+con&aqs=chrome.0.35i39j69i57j69i59i2j0i512i6.2449j0j...

Google ncdot connect

All News Shopping Maps Images More Tools

About 552,000 results (0.32 seconds)

https://connect.ncdot.gov :  
**Connect NCDOT: Home**  
Bringing Business and Government together with online collaboration.  
You've visited this page many times. Last visit: 7/28/22

**Bidding & Letting**  
Current and recently advertised Lets, Let results, and bidding ...

**Resources**  
Data and documents needed to work with the NCDOT.

**Doing Business**  
Consultants - Prequalify - Small Business - ...

**Projects**  
For businesses working on NCDOT Projects and Contracts.

[More results from ncdot.gov »](#)

The screenshot shows the 'Connect NCDOT BUSINESS PARTNER RESOURCES' website. The browser address bar displays 'connect.ncdot.gov/Pages/default.aspx'. The main navigation bar includes links for 'Home', 'Help', and 'Site Map', along with a search bar. Below this, a secondary navigation bar features 'Doing Business', 'Bidding & Letting', 'Projects', 'Resources', and 'Local Governments'. A blue arrow points to the 'Projects' link in this bar. A large black callout box with white text reads: 'Connect NCDOT Home Bringing Business and Government together with online collaboration.' Below the navigation, there are two main content areas: 'Browse All Sections' and 'More Site Content'. The 'Browse All Sections' area lists 'Doing Business', 'Bidding & Letting', 'Projects', and 'Resources'. A blue arrow points to the 'Projects' entry. The 'More Site Content' area lists 'Manuals', 'Maps', 'Training', and 'Groups & Committees'.

Home | Connect NCDOT

connect.ncdot.gov/Pages/default.aspx

Connect NCDOT  
BUSINESS PARTNER RESOURCES

Home Help Site Map

Doing Business Bidding & Letting Projects Resources Local Governments

Search...

**Connect NCDOT Home**  
Bringing Business and Government together with online collaboration.

**Browse All Sections**

- Doing Business**  
How to work with the North Carolina Department of Transportation.
- Bidding & Letting**  
Bidding and letting information for Central, Division, Design/Build and Bridge & Culvert Lets.
- Projects**  
For businesses working on NCDOT Projects and Contracts.
- Resources**

**More Site Content**

- Manuals**  
Important guides and handbooks from NCDOT.
- Maps**  
County, statewide and project-specific maps.
- Training**  
Certifications, course descriptions and online classes.
- Groups & Committees**  
Private and public organizations working with NCDOT.

Projects | Connect NCDOT

connect.ncdot.gov/projects/Pages/default.aspx

Connect NCDOT  
BUSINESS PARTNER RESOURCES

Home Help Site Map

Doing Business Bidding & Letting **Projects** Resources Local Governments

Search...

Planning Construction Research Roadway Design Work Zone Contracts Toolkit Bike & Pedestrian Project Management Value Management

**Projects**  
For businesses working on NCDOT Projects and Contracts.

Connect NCDOT > Projects

**Bike & Pedestrian** View Pages  
Guidelines and resources for development and design of Bicycle and Pedestrian Projects.

**Construction** View Pages  
Support for administration of NCDOT construction projects.

**Contracts**  
Standards, Specifications and Drawings for contract bid packages.

**Downloads**

New Updated Featured



## Construction Project Support

Support for administration of NCDOT construction projects.

Connect NCDOT > Projects > Construction

### Construction Manuals

Construction and Stakeout Manuals

[Read More](#) →

### Project Closeout

Construction Project Closeout Documents, and Final Acceptance Letters.

[Read More](#) →

### Contract Administration Guidance

New processes, procedures, guidelines, or policy memorandums related to the administration of contract construction projects.

[Read More](#) →

### Construction Resources

Construction forms, engineers maps, federal project resources, and roadway and structure bulletins.

[Read More](#) →

### Pavement Construction Documents

Worksheets, guides and specification sheets for pavement construction projects.

Featured Updated New

Equipment Watch Blue Book Rental Rate Web Service   
2019-12-03 10:24:31

Contract Payment Report   
2017-05-10 16:18:50

Revised Inspector Daily Diary   
2019-08-06 14:47:31

Project Closeout Report Application   
2015-09-23 11:57:05

### Highway Construction and Materials System (HiCAMS) Resources

HiCAMS User Manual  
Highway Construction and Materials System (HiCAMS) User Manual

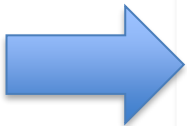



## Construction Resources

Construction forms, engineers maps, federal project resources, and roadway and structure bulletins.

Connect NCDOT > Projects > Construction > Construction Resources

Forms | Roadway Bulletins | Structure Bulletins | Federal Project Resources | Engineers Maps

### 1-CLAIMS

CCSF-1 Contractor Claim Submittal  
CCSF



ACRF-2 Claims Resolution Form Fillable  
ACRF-2



ACRF-1 Claims Resolution Form Fillable  
ACRF-1



**\*\*NEW\*\* 2022 Material Price Escalation Claim Form for Industry Partners**  
Please download to use (Do not check out via browser)



### 2-SUBCONTRACTING

BOWD Supportive Services Field Form  
Business Opportunity and Workforce Development Form



5-Day Notice DBE Replacement Letter - EXAMPLE



DBE MBE WBE Replacement Form and Instructions



Joint Check Notification Form and Procedures



Featured | Updated | New

Project Closeout Report Application  
2015-09-23 11:57:05



Revised Inspector Daily Diary  
2019-08-06 14:47:31



Contract Payment Report  
2017-05-10 16:18:50



Equipment Watch Blue Book Rental  
Rate Web Service  
2019-12-03 10:24:31



**Employee Directory**  
Staff contacts for *Construction Unit*.

**Contact Form**  
For questions & feedback



# Chief Engineer's Memo Highlights

- Excel spreadsheet includes sheet titled 'Instructions' that provides guidance on how to fill out each column included in the form
  - Please do not add columns to the form. Additional rows may be added as necessary to complete the submittal

# Completing Excel Spreadsheet

- Form should be completed by the Prime Contractor and should include all requests received from subcontractors/suppliers
- Columns 1-3
  - Provide the NCDOT Contract Number, the name of the Prime Contractor, and the Date this form is being submitted
- Column 4
  - Provide the name of the subcontractor requesting price adjustments
    - If the request is from the prime, this can remain blank

# Completing Excel Spreadsheet

- Column 5
  - Provide the name of the supplier the materials were purchased from
- Column 6
  - Enter the Contract Line Item Number the price adjustment is being requested for (**Leave Blank for Design-Build contracts**)
- Column 7
  - Enter the Line Item Description for the item the price adjustment is being requested for (**Leave Blank for Design-Build contracts**)

# Completing Excel Spreadsheet

- Column 8
  - Enter the materials associated with the Line Item in Column 6
    - Additional rows may be needed if multiple materials are associated with the Line Item
- Column 9
  - Enter the Unit of Measure of the Material in Column 8.
  - This is for the material, not the Line Item.
    - For example, if the Line Item is Guardrail, the Line Item Unit of Measure is Linear Feet. However, the Material Unit of Measure could be Each for some of the materials (Posts, Bolts, etc.)

# Completing Excel Spreadsheet

- Column 10
  - Enter the Material unit price at Time of Bid for the material on that row
- Column 11
  - Quantity of material that has been installed and permanently incorporated into the work at the time of the request.
    - No units are necessary in this column
- Column 12
  - Enter the Installed Material unit price for materials that have been permanently incorporated into the work.



# Completing Excel Spreadsheet

- **Column 13**
  - This Column will calculate automatically. There is no need to input any data in this column
- **Column 14**
  - Quantity of materials that will be permanently incorporated into the work prior to project completion
- **Column 15**
  - Current Material unit price based on recent quotes/invoices
- **Column 16**
  - This Column will calculate automatically. There is no need to input any data in this column

# Submitting Excel Spreadsheet

- The Excel spreadsheet, along with all supporting documentation, should be emailed to [NCDOTMaterialEscalationRequest@ncdot.gov](mailto:NCDOTMaterialEscalationRequest@ncdot.gov)
  - The Subject Line shall have the same naming convention as the excel spreadsheet
- All questions regarding these requests should be directed to [NCDOTMaterialEscalationRequest@ncdot.gov](mailto:NCDOTMaterialEscalationRequest@ncdot.gov)

# Submitting Excel Spreadsheet

- All questions regarding these requests should be directed to [NCDOTMaterialEscalationRequest@ncdot.gov](mailto:NCDOTMaterialEscalationRequest@ncdot.gov)

# Examples of supporting documentation

Material Price Escalation Claim Form for Industry Partners

Contract Number (1)	DG00534
Prime Contractor (2)	
Date Submitted (3)	7/18/2022

Subcontractor Name (4)	Supplier Name (5)	Contract Line Item Number (6)	Contract Line Item Description (7)	Material Associated with Contract Line Item (8)	Material Unit of Measure (9)	Material Price at Time of Bid (10)	Materials Permanently Incorporated Prior to Request			Materials Rem
							Installed Material Quantity (11)	Installed Material Price (12)	Additional Compensation (13)	Remaining Material Quantity (14)
	NUCOR / SKYLINE	65	HP 12X53 STEEL PILE	12X53 STEEL H-PILE	LF	\$ 40.47	\$ 91.50	\$ 44.67	\$ 363.83	\$ -
	GUARANTEED SUPPLY COMPANY	62	BRIDGE APPROACH SLAB, STATION *****(STATION 18+95.00-L	REINFORCING STEEL	LBS	\$ 0.76	2792	\$ 0.84	\$ 237.32	\$ -
	GUARANTEED SUPPLY COMPANY	62	BRIDGE APPROACH SLAB, STATION *****(STATION 18+95.00-L	EPOXY COATED REINFORCING STEEL	LBS	\$ 1.32	2046	\$ 1.50	\$ 368.28	\$ -
	GUARANTEED SUPPLY COMPANY	63	REINFORCING STEEL (BRIDGE)	REINFORCING STEEL	LBS	\$ 0.76	9400	\$ 0.84	\$ 799.00	\$ -
	GUARANTEED SUPPLY COMPANY	68	1'***X*****CONC PARAPET [1'-2" X 2'-10 1/2"]	EPOXY COATED REINFORCING STEEL	LBS	\$ 1.32	2023	\$ 1.50	\$ 364.14	\$ -
	GUARANTEED SUPPLY COMPANY	69	1'***X*****CONC PARAPET [1'-2" X 2'-9 3/4"]	EPOXY COATED REINFORCING STEEL	LBS	\$ 1.32	2023	\$ 1.50	\$ 364.14	\$ -
								\$ -	\$ -	\$ -
								\$ -	\$ -	\$ -
								\$ -	\$ -	\$ -
								\$ -	\$ -	\$ -

# Quote Information



Sales Rep: Matt Stephens  
 Phone: (770) 242-9007  
 Fax: (770) 242-0655  
 Email: [matt.stephens@nucorskyline.com](mailto:matt.stephens@nucorskyline.com)  
 Address: 3550 Corporate Way Suite E  
 Duluth, GA, 30098

## Quote # Q-41377

Project Name	Quote Date	Bid Date	Quote Expiration Date
NC DOT - DIV. 7 - ORANGE COUNTY - DG00534	Tuesday, November 16, 2021	Thursday, November 18, 2021	Thursday, November 25, 2021

## ALL BIDDING CONTRACTORS - GA

Customer Contact	Billing Address	Shipping Location
ESTIMATING	3550 Corporate Way Suite E DULUTH GA 770 USA	REPLACE BRIDGE #99 OVER NEW HOPE CREEK ON SR 1723 (NEW HOPE CHURCH ROAD) ORANGE COUNTY NC

## Quote Totals

Net Weight	Net Tons	Net Amount
11,452.00 lb	5.73	\$9,548.70

## General Remarks

- Freight included - CPT (Incoterms 2021) Orange County, NC
- Prices do NOT include tax
- Price in effect at time of order placement and/or mill rolling
- All material quoted as New Domestic, Bare Steel and A57250, unless otherwise noted below.
- Prices are based on below material, lengths and quantities. Any change may result in a price revision.
- It is the customer's responsibility to confirm and verify the below quoted material meets all project specifications and ordering process.
- All Skyline T&C's apply.

## Product Details

Product Name	Pieces	Units	Weight	Unit Price	Quoted Price	Optional
H PILE - 12X053 - A57250	1	210.00 ft	11,130.00 lb	\$40.47/ft	\$4,493.70	
OFFERING LENGTHS UP TO AND INCLUDING 50 FEET						
H-PILE POINT - 12 PAR12T - A148-96	14	-	322.00 lb	\$75.00/ea	\$1,050.00	
ADD \$45/EA TO ATTACH						

Total Weight: 11,452.00 lb    Total Price: \$9,548.70



# Installed Information

<b>NUCOR®</b>		<b>Invoice</b>																																					
<b>SKYLINE</b>		Reference																																					
Invoice 468842 Date 6/16/2022 Customer ID GACON7		(USD)																																					
Issued from: Skyline Steel - Georgia 3550 Corporate Way Suite E Duluth, GA 30096		(770) 242-9007 (770) 242-0655																																					
Invoice To: CONTI ENTERPRISES, INC 2045 LINCOLN HIGHWAY EDISON, NJ 08817		Remit-To Skyline Steel, LLC 24771 Network Place Chicago, IL 60673-1247																																					
VOUCHERED JUL 06 2022 Morgan		M-2106600/00011-001 (3)																																					
Terms of Payment: Net 45 INSTRUCTIONS FOR WIRES & OVERNIGHT: Wire Transfers & ACH: Skyline Steel LLC, Account # 826 077 992, ABA Routing: 021000021 SWIFT: CHASUS33, JPMorgan Chase Bank N.A. One Chase Manhattan Plaza, New York, NY 10005 Overnight: JPMorganChase, 131 S. Dearborn, 6th Floor, Chicago, IL 60603 Attn: Skyline Steel, LLC, Box 24771, (312) 336-2744																																							
Ship-To: CONTI ENTERPRISES, 35.513817, -78.815367, CPU@MCC, 9029 HIGHWAY 401, FUQUAY VARINA, NC 27526 Our Order: 301003, Your PO: 2022.01.20 (6/10/2022), Trade Terms: Customer P.U.C.E.X.W. (Incoterms 2020) Solina Location: Packing List: 284950-1 On 6/10/2022 From MCC By Customer Pickup																																							
<table border="1"> <thead> <tr> <th>Item</th> <th>Description</th> <th>Quantity</th> <th>Weight</th> <th>Price</th> <th>Amount</th> </tr> </thead> <tbody> <tr> <td>1-1</td> <td>H-PILE ASTM A572 Gr. 50 Bare HP 12x53 x 20'</td> <td>1 PCS</td> <td>1,060 LBS</td> <td>893.33/EA</td> <td>893.33</td> </tr> <tr> <td colspan="2">Q-50401</td> <td></td> <td></td> <td></td> <td>893.33</td> </tr> <tr> <td colspan="2">Mthd Pmt Check</td> <td></td> <td></td> <td></td> <td>42.43</td> </tr> <tr> <td colspan="2">Payment Due On 7/31/2022</td> <td></td> <td></td> <td></td> <td>20.10</td> </tr> <tr> <td colspan="2">Total Due (USD)</td> <td></td> <td></td> <td></td> <td>955.86</td> </tr> </tbody> </table>				Item	Description	Quantity	Weight	Price	Amount	1-1	H-PILE ASTM A572 Gr. 50 Bare HP 12x53 x 20'	1 PCS	1,060 LBS	893.33/EA	893.33	Q-50401					893.33	Mthd Pmt Check					42.43	Payment Due On 7/31/2022					20.10	Total Due (USD)					955.86
Item	Description	Quantity	Weight	Price	Amount																																		
1-1	H-PILE ASTM A572 Gr. 50 Bare HP 12x53 x 20'	1 PCS	1,060 LBS	893.33/EA	893.33																																		
Q-50401					893.33																																		
Mthd Pmt Check					42.43																																		
Payment Due On 7/31/2022					20.10																																		
Total Due (USD)					955.86																																		
Inside Justin Muldowney Outside Matt Stephens Taken-by Stp Natalie Schwamb (708) 444-0999 (708) 444-0990																																							
RECEIVED JUN 27 2022 By Morgan																																							
Ok to pay? <input type="checkbox"/> Yes <input type="checkbox"/> No Change Order? <input type="checkbox"/> Yes <input checked="" type="checkbox"/> No Approved by: <u>Hayden Mahmood</u> Account No: <u>2106600.5040-2PI25</u> Date: <u>06/22/2022</u>																																							

<b>NUCOR®</b>		<b>Invoice</b>																																																													
<b>SKYLINE</b>		Reference																																																													
Invoice 468843 Date 6/16/2022 Customer ID GACON7		(USD)																																																													
Issued from: Skyline Steel - Georgia 3550 Corporate Way Suite E Duluth, GA 30096		(770) 242-9007 (770) 242-0655																																																													
Invoice To: CONTI ENTERPRISES, INC 2045 LINCOLN HIGHWAY EDISON, NJ 08817		Remit-To Skyline Steel, LLC 24771 Network Place Chicago, IL 60673-1247																																																													
VOUCHERED JUL 06 2022 Morgan		M-2106600/00011-001 (4-6)																																																													
Terms of Payment: Net 45 INSTRUCTIONS FOR WIRES & OVERNIGHT: Wire Transfers & ACH: Skyline Steel LLC, Account # 826 077 992, ABA Routing: 021000021 SWIFT: CHASUS33, JPMorgan Chase Bank N.A. One Chase Manhattan Plaza, New York, NY 10005 Overnight: JPMorganChase, 131 S. Dearborn, 6th Floor, Chicago, IL 60603 Attn: Skyline Steel, LLC, Box 24771, (312) 336-2744																																																															
Ship-To: CONTI ENTERPRISES, 35.513817, -78.815367, CPU@MCC, 9029 HIGHWAY 401, FUQUAY VARINA, NC 27526 Our Order: 301003, Your PO: 2022.01.20 (6/10/2022), Trade Terms: Customer P.U.C.E.X.W. (Incoterms 2020) Solina Location: Packing List: 284950-1 On 6/10/2022 From MCC By Customer Pickup																																																															
<table border="1"> <thead> <tr> <th>Item</th> <th>Description</th> <th>Quantity</th> <th>Weight</th> <th>Price</th> <th>Amount</th> </tr> </thead> <tbody> <tr> <td>2-1</td> <td>H-PILE ASTM A572 Gr. 50 Bare HP 12x53 x 20'</td> <td>1 PCS</td> <td>1,060 LBS</td> <td>893.33/EA</td> <td>893.33</td> </tr> <tr> <td colspan="2">Q-50401</td> <td></td> <td></td> <td></td> <td>893.33</td> </tr> <tr> <td>3-1</td> <td>H-PILE ASTM A572 Gr. 50 Bare HP 12x53 x 15'</td> <td>1 PCS</td> <td>795 LBS</td> <td>670.00/EA</td> <td>670.00</td> </tr> <tr> <td colspan="2">Q-50401</td> <td></td> <td></td> <td></td> <td>670.00</td> </tr> <tr> <td>1-1</td> <td>H-PILE ASTM A572 Gr. 50 Bare HP 12x53 x 20'</td> <td>1 PCS</td> <td>1,060 LBS</td> <td>893.33/EA</td> <td>893.33</td> </tr> <tr> <td colspan="2">Totals</td> <td></td> <td>2,915 LBS</td> <td></td> <td>2,456.66</td> </tr> <tr> <td colspan="2">Mthd Pmt Check</td> <td></td> <td></td> <td></td> <td>116.69</td> </tr> <tr> <td colspan="2">Payment Due On 7/31/2022</td> <td></td> <td></td> <td></td> <td>55.27</td> </tr> <tr> <td colspan="2">Total Due (USD)</td> <td></td> <td></td> <td></td> <td>2,628.62</td> </tr> </tbody> </table>				Item	Description	Quantity	Weight	Price	Amount	2-1	H-PILE ASTM A572 Gr. 50 Bare HP 12x53 x 20'	1 PCS	1,060 LBS	893.33/EA	893.33	Q-50401					893.33	3-1	H-PILE ASTM A572 Gr. 50 Bare HP 12x53 x 15'	1 PCS	795 LBS	670.00/EA	670.00	Q-50401					670.00	1-1	H-PILE ASTM A572 Gr. 50 Bare HP 12x53 x 20'	1 PCS	1,060 LBS	893.33/EA	893.33	Totals			2,915 LBS		2,456.66	Mthd Pmt Check					116.69	Payment Due On 7/31/2022					55.27	Total Due (USD)					2,628.62
Item	Description	Quantity	Weight	Price	Amount																																																										
2-1	H-PILE ASTM A572 Gr. 50 Bare HP 12x53 x 20'	1 PCS	1,060 LBS	893.33/EA	893.33																																																										
Q-50401					893.33																																																										
3-1	H-PILE ASTM A572 Gr. 50 Bare HP 12x53 x 15'	1 PCS	795 LBS	670.00/EA	670.00																																																										
Q-50401					670.00																																																										
1-1	H-PILE ASTM A572 Gr. 50 Bare HP 12x53 x 20'	1 PCS	1,060 LBS	893.33/EA	893.33																																																										
Totals			2,915 LBS		2,456.66																																																										
Mthd Pmt Check					116.69																																																										
Payment Due On 7/31/2022					55.27																																																										
Total Due (USD)					2,628.62																																																										
Inside Justin Muldowney Outside Matt Stephens Taken-by Stp Natalie Schwamb (708) 444-0999 (708) 444-0990																																																															
RECEIVED JUN 27 2022 By Morgan																																																															
Ok to pay? <input type="checkbox"/> Yes <input type="checkbox"/> No Change Order? <input type="checkbox"/> Yes <input checked="" type="checkbox"/> No Approved by: <u>Hayden Mahmood</u> Account No: <u>2106600.5040-2PI25</u> Date: <u>06/22/2022</u>																																																															



# Examples of supporting quote documentation



Quotation No: Orange Co DG00534

Date: November 15, 2021

To: Bidding Contractor

Subject: Orange Co DG00534  
Loc.: Orange Co, NC

Attn: Estimating Department

JMS Rebar (the Seller) purposed to furnish:

The necessary reinforcing steel meeting the requirements of ASTM A615 grade 60 / A615M-96a Grade 420 (latest rev.) steel cut, bent, bundled and tagged, including placing drawings, in accordance with the project plans and specifications, and the CRSI Manual of Standard Practice (latest rev.), delivered in 40,000# truckload quantities to the nearest accessible jobsite point, unloading not included.

This quotation is offered for acceptance within 3 days, after which it is subject to confirmation

Unit Price ASTM/A615 Grade 60 plain rebar at \$0.7595/lb

Unit Price ASTM/A775 Grade 60 Epoxy Coated rebar at \$1.3150/lb

Engineering Cost incurred for cancelled, or postponed projects will be invoiced @ \$75.00/ hour

The following are excluded:

- a) Precast item of any kind, including but not limited to lintels, sills, interior tie lintels or masonry dur-o-wall type reinforcing.
- b) Reinforcing where welded to structural steel.
- c) Side form supports or spacers for poured walls or masonry.
- d) Bar supports to support bottom layer of reinforcing bars or mesh in slabs on grade
- e) Stamp or review of placing drawings by a professional engineer.
- f) Smooth round bars and threading of any kind, unless specifically mentioned above.
- g) Supports for upper layer rebar in concrete slabs more than 4 feet thick.
- h) Cost of any Supply Bonds.
- i) Masonry reinf. detailed in elevation
- j) Sheared Bar Lengths under 2'-0" for bar sizes #6 through #18
- k) Post Tensioning bars & supports.
- l) Masonry rebar

**Due to variations in the World Steel Industry we are forced to quote our prices on a day by day basis. We will adjust prices according to the industry behavior. We suggest that you include this in your contract in order for you to be able to make changes if necessary.  
We will invoice according to cost at time of delivery.**

SUBJECT TO THE TERMS AND CONDITIONS HEREIN AND THOSE PRINTED UNDER "TERMS AND CONDITION OF SALE," which are hereby referred to and made part of this quotation,

JMS REBAR  
(A Subsidiary of Guaranteed Supply Company)  
1211 Rotherwood Road, Greensboro, NC 27406 Phone 336-274-7099

# Examples of supporting installed documentation

**PURCHASE ORDER**

CONTI ENTERPRISES, INC.  
 2045 Lincoln Highway  
 Edison, N.J. 08817  
 Tel #: (732) 520-5100  
 Fax #: (732) 520-5199  
 (Hereinafter "Conti")

DATE: 03/03/2022

PURCHASE ORDER NO. \_\_\_\_\_

PROJECT NAME: Replace Bridge #99 Over New Hope Creek, Contract ID: DG00534

PROJECT OWNER: North Carolina Department of Transportation

ISSUED TO:

Guaranteed Supply Company / JMS Rebar  
 1211 Rotherwood Rd  
 Greensboro, NC 27406

(Hereinafter "Supplier")

SHIP TO:

Conti Enterprises, Inc.  
 SR 1723 New Hope Church Road – Replace Bridge #99 Over New Hope Creek Project, Chapel Hill, NC 27516  
 (Exact Location and or address to be provided)

(Hereinafter "project site" or "jobsite")

Subject to CONTI's attached Standard Terms and Conditions, which are incorporated herein by reference and are an integral part of this Purchase Order, CONTI hereby orders from Supplier the following Material and/or Equipment for delivery to CONTI's above-referenced project jobsite:

**ITEMS TO BE SUPPLIED**

ITEM #	CLIN #	DESCRIPTION	ESTIMATED QUANTITY	UNIT	UNIT PRICE	EXTENSION
1	0063	Reinforcing Steel (BRIDGE) PLAIN REBAR ASTM A615 GRADE 60	9,588	LB	\$0.8445	\$8,097.066
2	0068 0069	Reinforcing Steel (CONCRETE PARAPET) EPOXY COATED REBAR ASTM/A775 GRADE 60	4,127	LB	\$1.4950	\$6,169.865
3	0062	Reinforcing Steel (APPROACH SLAB) PLAIN REBAR ASTM A615 GRADE 60	2,948	LB	\$0.8445	\$2,405.136
4	0062	Reinforcing Steel (APPROACH SLAB) EPOXY COATED REBAR ASTM/A775 GRADE 60	2,087	LB	\$1.4950	\$3,120.065
5	0062	Approach Slab Material				
5.a		TYPE1 FABRIC MIRAFI 140N 12.5'X360'	1	ROLL	\$432.00	\$432.00
5.b		4'X10' BELL END SCH40 PVC AASHTO M278	8	EA	\$46.00	\$368.00
5.c		4'X20' BELL END SCH40 PVC	2	EA	\$205.00	\$410.00
5.d		4" PVC CAPS	2	EA	\$18.00	\$36.00
5.e		4" 60DEG ELBOWS	2	EA	\$28.00	\$56.00

PO Agreement  
 Conti Enterprises 12/11

ITEM #	CLIN #	DESCRIPTION	ESTIMATED QUANTITY	UNIT	UNIT PRICE	EXTENSION
6		BRIDGE REBAR ACCESSORIES/SUPPORTS	1	LS	\$430.00	\$430.00
6.a		70 LF 3" BB				
6.b		280 LF 4" SBU				
6.c		280 LF 5-1/4" CHCU				
7		MISC BRIDGE MATERIAL				
7.a		30# FELT	2	ROLL	\$15.10	\$30.20
7.b		7BOLT GUARDRAIL ANCHOR PLATES WITH (7) 7/8"X16" HDG B NW	4	SET	\$127.75	\$511.00
7.c		2"X6" BACKER ROD	12	EA	\$2.60	\$31.20
<b>TOTAL</b>						<b>\$22,096.532</b>

**TOTAL PRICE OF ORDER: \$22,096.532**  
 (Plus, any applicable taxes)

# Examples of documentation needing more supporting information

[REDACTED]

OFFICE: 704 [REDACTED]  
MOBILE: 704 [REDACTED]

The original line item amount is \$18,551.63  
The current line item amount is \$24,956.45  
The requested escalation amount is \$6,404.82  
The NCDOT provided spreadsheet is attached to this correspondence.

If you have questions, comments, or need more information, please contact  
[REDACTED] project manager, [REDACTED] or 704-[REDACTED]

July 27, 2022

[REDACTED]

Respectfully,  
[REDACTED]  
President,  
[REDACTED], Inc.

NCDOT Contract: DG00 [REDACTED]  
Project: Replace bridge # [REDACTED]  
County: Orange  
Reference: Material Price Escalation Request for Two Bar Metal Rail

[REDACTED]:

[REDACTED] Inc. requests material price escalation in accordance with NCDOT memorandum dated July, 12, 2022 from Chief Engineer, C.A. Peoples, PE.

[REDACTED] Inc. has a subcontract with [REDACTED] to furnish and install 194.38 linear feet of NCDOT standard two bar metal rail on the new bridge.

[REDACTED] has not installed any materials on the project. [REDACTED] will purchase the two bar metal rail system from Structural Materials, Inc.

The original two bar metal rail system price was \$89.40 per linear foot plus NC and [REDACTED] County, NC tax at 6.75%, or \$95.44 per linear foot.

The current two bar metal rail system price is \$120.27 per linear foot plus NC and [REDACTED] County, NC tax at 6.75%, or \$128.39 per linear foot.

# Common Questions

- What are materials permanently incorporated into the work?

Any material which remains incorporated into the work at the time of project acceptance.

# Common Questions

- How to address multiple invoices for the same material?
  - If a material that has been permanently incorporated into the work was purchased separate times at different unit prices, please add rows as necessary to show the quantity purchased and corresponding unit price from each invoice.

# Common Questions

- If a subcontractor has completed their portion of the work on an eligible contract, but the Final Estimate has not been paid, Can the subcontractor still submit an escalation request?
  - Yes, The contract is eligible for material escalation requests. The Subcontractor should work through the Prime Contractor to submit their request.